

Redirack



*REDIRACK
STORAGE SYSTEMS
FOR LIFE!*

RediDrive

Redirack is manufacturer of storage systems since 1952 (CORNIX group)

REDIDRIVE® • DRIVE-IN & DRIVE-THROUGH

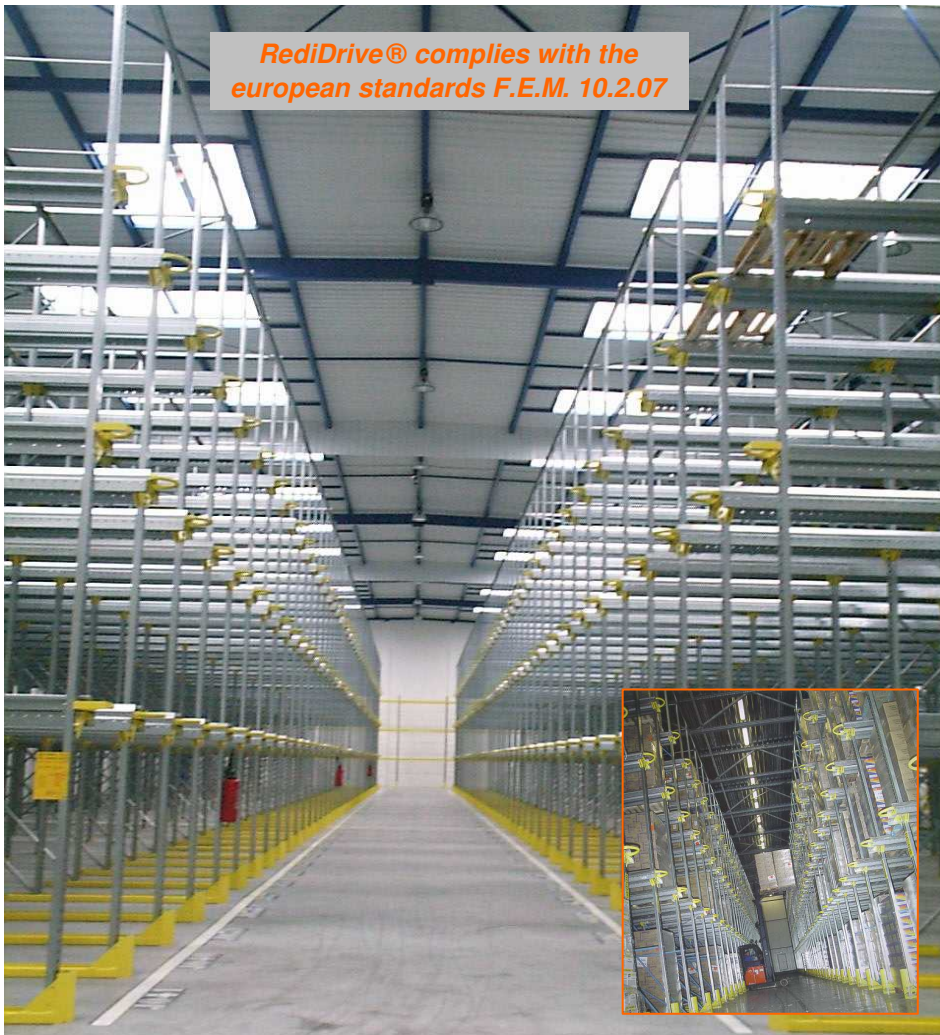

**CALCULATE
AND SAVE !**

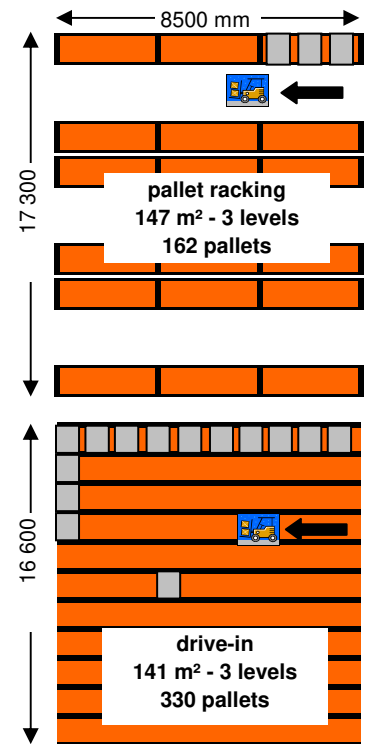

your gain : 100 % !

Delivered not assembled. 
On request our specialized
installers will install your drive-in.
Ask for a free quote !

**Our engineers are at your disposal to make a free quote
based on your requirements. Consult us !**



REDIRACK DRIVE-IN SYSTEM "REDIDRIVE®"

The REDIRACK DRIVE-IN SYSTEM "RediDrive®" is indispensable where big quantities of the same product with a high turnover rate have to be stored.

The DRIVE-IN system is based on the LIFO principle i.e. last in, first out. Providing a change in design your DRIVE-IN can be altered into a DRIVE-THROUGH. This system is then based on the FIFO principle i.e. first in, first out.

The occupied space needed by the DRIVE-IN system REDIRACK "RediDrive®" is minimal, as only a minimum of aisles are required. One drives "in" or "through" the installation. This is of great importance where available space is either limited or expensive.

(e.g. freezers or refrigerated areas).



- 1 Continuous **frame protector** "boat" type.
An absolute must in order to avoid damage to the frames caused by forklift trucks.
These protectors are anchored to the floor.
- 2 **Stability tunnel** for an increased stability.
- 3 **Other colours** are available at extra charge.
Standard colours : frames, bracing, beam rails, ... : sendzimir. Brackets, protections, entry guides, ... : yellow RAL 1018.
- 4 The sendzimir beam rails are fixed to the **brackets** which are available in different types and sizes as to optimize your installation.
Different types of **rails** are available as to meet with your requirements : with or without nose, angle, ...
Entry guides : protects the upright from shocks caused by pallets and guides the pallets into the bay. Available single- or double-sided.
Bracing at the back and above. Width (110, 127, 140 or 160 mm) and gauge of **upright** according to the requested loads.

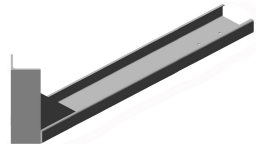



YOUR CHOICE OF COLOURS

Standard colour for this product (6 to 8 weeks) :

Zinc yellow ral 1018
 (bracing, uprights and rails : sendzimir)



Other standard colours with 5% surcharge
 (lead time 6 to 8 weeks) :

Ivory (cream) ral 1013
 Orange-red ral 2002
 Gentian blue ral 5010
 Light grey ral 7035
 (bracing, uprights and rails always sendzimir)

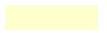

Other ral colours at extra cost (lead time +/- 8 weeks)

(bracing, uprights and rails always sendzimir).

Hot dipped galvanized version available at extra cost (+/- 10 weeks)

OTHER REDIRACK® PRODUCTS



RediRack
Pallet racking



RediBuild
Covered storage

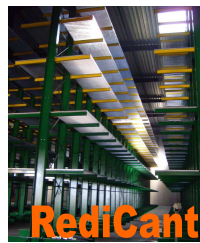

RediCant
Cantilevers

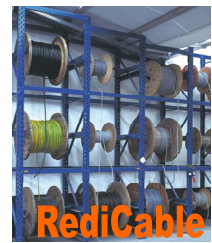

RediCable
Cable drum storage

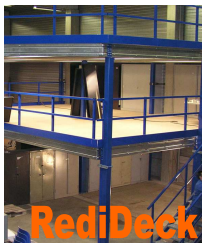

RediDeck
Mezzanines



RediTab
Shelving systems



RediRoll
Dynamic storage



RediSpan
Long span



STORAGE SYSTEMS FOR LIFE

www.redirack.eu

REDIRACK FLANDERS ANTWERPEN (Kiel)

Boomssteenweg, 492
B-2020 Antwerpen

☎ ++/32/(0)3/240 11 30
 ☎ ++/32/(0)3/825 30 90
 ✉ sales@cornix.eu

REDIRACK NETHERLANDS DOETINCHEM (no showroom)

Kruidenlaan 7
NL-7060 TD Doetinchem

☎ ++/32/(0)3/240 11 30
 ☎ ++/32/(0)3/825 30 90
 ✉ sales.nl@cornix.eu

REDIRACK WALLONIA NIVELLES

Rue de la Recherche 6A, Z.I. 1 Nivelles Sud
B-1400 Nivelles

☎ ++/32/(0)67/411 241
 ☎ ++/32/(0)67/411 249
 ✉ sales@cornix.be

REDIRACK EXPORT SALES NIVELLES

Rue de la Recherche 6A, Z.I. 1 Nivelles Sud
B-1400 Nivelles

☎ ++/32/(0)67/894 225
 ☎ ++/32/(0)67/894 220
 ✉ export@cornix.eu